



SUPERSTAR

112' (34.14m) :: WESTPORT :: 2001 :: GUESTS :: 4 CABINS :: CREW :: ASKING PRICE \$4,295,000 USD

OVERVIEW

Type	Motor Yacht Raised Pilothouse	Builder	WESTPORT
Top	Hardtop	Naval Architect	JACK SARIN
Year Built	2001	Interior Design	WESTPORT
LOA	112' (34.14m)	Hull	Fiberglass
Beam	23' (7.01m)	Deck	Teak
Draft	5' 6" (1.68m) Max	Engines	1800 HP, Twin, Inboard, Diesel, MTU, 16V2000, 615hrs / 615hrs
GRT	0.00	Max Speed	24 Knots
Fuel	5500 Gal	Cruise Speed	20 Knots
Water	1000 Gal	Location:	Washington D.C., District of Columbia, United States
Flag	United States		

★★★★★
Alex Rogers

T-+1 (954) 522-3344

M-+1 (954) 401-9988

ALEX.ROGERS@NORTHROPANDJOHNSON.COM

INTRODUCTION / ACCOMMODATIONS

"SUPERSTAR" is a yacht designed for ultimate comfort and style. This overview provides a glimpse into her features and layout.

"SUPERSTAR" offers convenient boarding options, either from midship or the Swim Platform. The Swim Platform leads to Teak decks and stairs on both sides, providing access to the Aft Deck.

Upon reaching the Aft Deck, a curved u-shaped seating area with a Teak table welcomes guests. To enhance the onboard experience, a bar with a sink, undercounter refrigerator, and icemaker is positioned to port.

Double stainless sliding doors lead from the Aft Deck to the Salon. Inside, a sophisticated atmosphere awaits with a bar, sofas, and a formal Dining area for eight guests. Stone countertops adorn the Galley, which features a Country Kitchen design with stainless appliances.

The Main Deck hosts the Master Stateroom, full-beam with a King Berth, cedar-line closet, and his-and-her heads connected by a spacious walk-in shower. The VIP Stateroom and two Guest staterooms, each with en-suite heads, are accessible via Companionways.

Accessed from midship, the Pilothouse boasts a large settee and well-laid-out electronics. A glass sliding door leads to the Flybridge with a main Helm, bar, seating, and a hot tub with a sunpad cover. A 2000lb. Davit is available for lifting toys.

The Crew Quarters, including a Captain's Cabin and two Crew Cabins, feature en-suite heads. The Engine Room, accessible through a watertight door, houses rebuilt MTU 16V2000 main engines. Recent upgrades include a new Bow Thruster, serviced Stabilizers and bow Windlass replacement.

"SUPERSTAR" stands out with its recent upgrades. Ready for cruising with rebuilt engines and meticulous maintenance, it promises an unparalleled yachting experience for its new Owner.

UPDATES AND IMPROVEMENTS

- New Carpeting throughout Vessel
- New Dining Table and chairs
- Bottom Paint (1/2024)
- Hardtop and Arch
- Hot Tub: Heat Pump, Display, LED multi-color Lights (2019)
- Perko Navigation Lights LED (2018)
- Second Viking Life Raft with new matching stainless Cradle (2018)
- ACR RCL600A Search Light (2020)
- Furuno SAT Compass (2020)
- Starboard Midship Shore Power moved to port aft Swim Platform (2020)

- LED Imtra overhead lights Aft Deck and Flybridge (2019)
- Flybridge slider door completely rebuilt (2020)
- Mesh Pilothouse window cover
- Underwater Light LED Ballasts on all five underwater lights
- Marquipt Step-Across Boarding Step (2020)
- Exterior covers
- JL Audio Sound System installed on Main deck, Flybridge, and Boat Deck
- JL Audio Speakers on Foredeck
- Custom Stainless Anchor Bow Plate

AFT DECK

- Custom teak dining table, accommodates eight
- U-shaped seating with cushions and pillows
- Custom Bar/Buffer with stone countertops
- Manitowoc icemaker and refrigerator (2018)
- Custom Teak deck with compass rose inlay and teak stairs to upper bridge
- Hot & cold water shower

SALON

- (2) Upholstered sofas
- Coffee table
- Samsung 60" Flatscreen TV with pop-up lift and swivels
- Wii Player
- Custom bar with new stone top
- Perlick under-counter refrigerator and wine cooler
- Scottsman refrigerator and icemaker
- (4) Leather chairs
- Custom wall coverings
- Built-in cabinetry for storage with new stone tops to port and starboard
- Scottsman Icemaker (2018)
- Serving bar
- Custom Electric Blinds
- Recessed LED overhead Lighting

DINING

- Custom overhead lighting with circular soffit
- Custom rectangular Dining table
- (8) Upholstered chairs

DAY HEAD

- Granite vanity top
- Sink
- Toilet
- Custom wall covering
- Marble floors

GALLEY

- Induction Stovetop (New 2022)
- Viking Professional Oven
- GE Microwave
- Stainless steel Hood
- Sub-Zero Commercial grade refrigerator with four drawers
- Miele Dishwasher
- Insinkerator Garbage Disposal
- Stone countertops (New 2022)
- Large u-shaped settee with stone countertops accommodates 8-10 guests
- New wall coverings
- Samsung 32" LED Flatscreen TV
- LED Lighting
- Wood flooring

DOGHOUSE: Chest freezer and (2) Sub-Zero under-counter refrigerators. A/V Rack (2018)

PILOTHOUSE

- Stairwell Entry port and starboard
- Electronic Engine Controls DDEC/MTU
- Centerline Helm Station with 24" stainless wheel
- Built-in Settee with large table
- Bow Thruster
- VKool Window Tint
- (3) KEP Monitors
- Nobeltec Chart Plotter
- (2) Icom VHF M604 Radio
- Garmin HD2 Radar
- Furuno 25kW Radar
- Simrad AP48 Autopilot
- Ritchie Compass
- B&G Sounder
- Furuno GP-33 GP
- Garmin GPS Maps 8416
- Furuno AIS FA-170
- ACR RCD 600A Spotlight
- Satellite TV
- New LED Lighting
- Carpeting

ELECTRONICS / NAVIGATIONAL EQUIPMENT

- Satcom(s): KVH-HD Direct TV Dome
- Satellite TV Receiver: SeaTel3400
- SSB: Stephens SEA 235 SSB Radio
- Bridge: (2) ICOM VHF M604
- Flybridge: ICOM IC-M504 & M604 control mic.
- HP Office Jet 250 Printer
- Radar: Furuno FAR1523 25kw Radar & Garmin HD2 Radar
- Autopilot: SIMRAD AP48 & AP44
- Compass: 2x Ritchie in the pilothouse & Flybridge
- Satellite Compass: Furuno SC-702 (2020)
- Depth Sounder - B&G HS 2000, AIRMAR 235 kHz (2020)
- FURUNO GP-33 GPS
- Nobeltec Chart plotter (2018)

- Garmin GPSMaps8416 & GPSMaps8412 Chart Plotter
- (3) Glass Bridge KEP Monitor
- Furuno FA-170 Class A AIS
- Kahlenberg-M512 Ship's Horn Signaler; refinished by Kahlenberg
- ACR RCL600A Spotlight

VIP STATEROOM - FORWARD

- Centerline Queen Berth with custom bedspread and pillow shams
- (2) Built-in nightstands
- Samsung 32" LED Flatscreen TV
- Cedar-lined closet
- Built-in dresser
- Drawer storage throughout
- En-suite Head with stall shower, head and vanity with sink

MASTER STATEROOM

- Centerline King Berth with and storage underneath and custom bedspread and pillow shams
- Mirrored bulkhead with custom upholstered panels
- Samsung 32" LED Flatscreen TV
- Semi-round mirrored overhead soffit with custom upholstery and LED lighting
- Built-in nightstands
- Built-in dressers with cedar-lined drawers
- Cedar-lined walk-in closet
- Large custom Soffit
- LED Lighting
- Custom window treatments
- Carpeting and wall coverings
- His & Hers Master Bath with walkthrough shower, heads and vanities with sinks

GUEST STATEROOM / PORT

- Centerline Queen Berth with custom bedspread and pillow shams
- Mirrored bulkhead with custom upholstered panels

- Samsung 32" LED Flatscreen TV
- Built-in nightstands
- Custom wall coverings
- LED lighting
- Cedar-lined closet
- Carpeting
- Private bath with shower stall and head

GUEST STATEROOM / STARBOARD

- Queen offset Berth with custom bedspread and pillow shams that can be converted into (2) Twin Berths
- Samsung 32" LED Flatscreen TV
- Bulkhead with mirrors and custom upholstered panels
- Built-in nightstands
- Cedar-lined closet
- LED Lighting
- Custom wall covering and carpeting
- En-suite head with sink and shower stall

CREW QUARTERS

- Sharp 21" LCD Flatscreen TV
- GE Microwave
- Sub-Zero under-counter refrigerator
- (2) Sub-Zero under-counter freezer
- (2) Sets of Washer/Dryer

INTERIOR UPDATES

- Added oak cabinets to Galley forward wall
- Added Galley cabinets underneath Peninsula
- Day Head wallpaper (2020)
- Salon wallpaper (2020)
- Pilothouse wall coverings (2019)
- VIP Wallpaper and headboard and seating upholstery (2020)

- Guest cabins wallpaper and headboard panels (2020)
- Lower guest foyer wall coverings and artwork (2019)
- Master Stateroom - Whisperwall coverings, headboard and ceiling board panel coverings (2020)
- Master Head wallpaper (2020)
- LED Warm white rope lights installed throughout entire vessel (2020)
- Pilothouse IMTRA LED overhead lights - stainless, warm white (New)
- Stainless Cantalupi LED stair lights - Pilothouse, VIP stairs, lower guest foyer stairs (New)
- Chrome VIMAR outlet covers in Master Stateroom, Salon, VIP Stateroom, Galley and Pilothouse (New)
- Motorized window and porthole blinds installed in Salon, Galley, Master Stateroom, port and starboard Guest Staterooms (New)
- Dining table and Dining table light (New)
- VKool Window tint on all windows (New)
- Crew bunk added to Captain's Cabin (New)

AUDIO AND VISUAL EQUIPMENT

- Pepwave Cellular/Wave Wi-Fi Antenna - 5ghz. (2019)
- Apple TV installed on every TV
Music is controlled by iPad and personal devices via Airplay, each zone is
- independent a party mode via whole boat airplay
- Axis Digital Camera system added. Cameras added to port and starboard entrance, Flybridge, Aft Deck, Engine Room, and Swim Platform.
Can be accessed from Axis application anywhere in the world. (2018)
- Most recent 5GHz wireless/Cellular Peplink Router/Antenna. Wave Wi-Fi 5GHz access speeds (2019)
- KVH HD7 Direct TV Dome
- Additional JL Audio Sound system added to Boat Deck

FLYBRIDGE

- Centerline Helm Station with full instrumentation
- 24" stainless Helm wheel
- EZ2CY Enclosure
- Kahlenberg horns
- Wing Stations - port and starboard
- Bow Thruster
- (2) Stidd Helm chairs
- LED Lighting
- Wet bar with Corian countertop and sink

- Hishotaki Icemaker
- (5) Barstools
- Refrigerator and icemaker
- Stainless steel grill
- Built-in bench seating with Teak table top and fold-out leaves, starboard
- (2) Reclining high-back Teak dining chairs
- Large molded in Hot Tub with sunpad cover
- (2) 2020 Yamaha Wave Runners
- 2000Lb. Nautical Structures Davit

DECK AND HULL

- Anchor Windlass - 4500 Maxwell Hydraulic Winch
- Deck Capstans – (2) Maxwell DC Capstans on Swim Platform
- (1) 350Lb. Fjord Anchor (Galvanizing in 2018)
- 350' 5/8" Anchor Chain
- 5/8" Chrome Chain Stopper
- Nautical Structures 2000lb. SWL Davit with Power Telescoping Hydraulic Boom and Rotation
- Generac Gas portable crash and fire pump with fire hose (Serviced annually)
- Halon Fire System with auto/manual Controls (Serviced annually)
- Hand-held Fire Extinguishers throughout (Serviced annually)
- SIREN Marine Text Alarm System (Installed 2020)
- Composite Fiberglass composed of E-Glass Construction

ELECTRICAL SYSTEMS

- 50kW Northern Lights - since rebuild port/5884
- 65kW Northern Lights - since rebuild starboard/5728
- Shore Power Volts: 240v AC Single Phase 60Hz
- Output Volts: 120/240v AC Single Phase 60Hz
- Power Converter: (2) 100amp Charles Industries isolation transformers with one-step auto voltage adjustment
- Main engine starting: 2 banks x 2 batteries each 8-D AGM
- Single Battery on each generator - KMF8FD
- House Batteries: 1 bank x 4 batteries - 8-D AGM
- Shore Power Cords added 100' and 110'
- (2) Additional Shore Power was removed and re-routed to the port Swim Platform Quarter. Each Swim Platform quarter now houses a Shore

- Power cord (2020)
- Generator 8D batteries (2019)
- Generator Starters (2020)
- Generator Alternators (2019)

ENGINE AND MECHANICAL EQUIPMENT

- (2) MTU 16V2000 DDEC @1800HP
- Engine Hours after rebuild: Port: 615 hrs. (01/2024) Stbd: 615 hrs. (1/2024)
- Metcalf Exhaust Risers (2020)
- Gearbox: Port & Stbd. Transmissions (Rebuilt 2021)
- Air-Conditioning: Marine Air 15-ton Chilled Water System, with 12 air handlers (Installed new in 2015)
- Air Handlers in Pilothouse, Galley, and Crew (New in 2018)
- Aquamiser FCI - 1800 gpd (New Membranes, New HP Pump 2019, New LP Pump 2020)
- Naiad Stabilizers with 9 sq. ft. Fins and 2-Station Control. Adaptive Control System with Speed Sensor (Installed 2018, Actuators refurbished 2020)
- Aquamatic 1800 gpd (New Membranes, New HP Pump 2019, New LP Pump 2020)
- Helm Controls – (4) Pilothouse, Flybridge, port & starboard Wing Stations
- Steering - Jastram CCO Commercial Steering with Dual Engine Driven Pumps
- 16" Wesmar 40hp Hydraulic with 4-Station Controls Bow Thruster
- Main Engines Fuel Filtration System replaced to Racor System
- Water Softener System: Spot Zero (2018, New Power Supply 2020)
- Edson AC Black water pump (Rebuilt in 2018), 24V DC black water pump (2019), Headhunter toilets in guest areas; Galley Maid toilets in Crew area (New 2019)
- 220V Air Compressor (2018)
- Emergency Bilge Pump
- Stainless steel workbench with 4" vice
- (8) Bilge Pumps
- Delta T Intake/Exhaust ventilation with Fire Dampers installed by Gillen Diesel (2018)
- Fire Suppression System installed in Crew area electrical panel (2020)
- Stabilizers complete overhaul and new seals (12/2019)
- Adaptive Naiad Datum Controller System installed (2018) necessary for AT REST Stabilizers
- HVAC Duct System was cleaned and sanitized by Blue Star (2019)
- Raw Water and Chill Water Pumps added (2018)
- Engine Room Flat Panel LED Lighting added (2018)
- Laundry Room Flat Panel LED Lighting added (2018)
- Cutlass bearings, rudder seals, and shaft seals (January 2020)

- Engine Motor mounts and Shaft/Engine Laser Alignment by Crawford Marine (1/2020)
- Generator Intake thru-hull ball valves (January 2020)
- Upper and lower Watermaker low-pressure pumps (2020)
- Engine Room Chiller Plant Insulation (2020)

EXCLUSIONS

"SUPERSTAR" is a registered name and does not convey.

All of the Artwork is excluded from the sale of this vessel.

Exclusions are to include but are not limited to, all owner's personal items. A detailed list of exclusions will be provided at the time of sale, upon written request.

DISCLAIMER

Details of this vessel are offered in good faith but we cannot guarantee or warrant the accuracy of this information nor warrant the condition of the vessel. Buyer should instruct his agents, and/or his surveyors, to investigate such details as the buyer desires validated. This vessel is offered subject to prior sale, price change, or withdrawal without notice.

AFT DECK



AFT DECK



AFT DECK



AFT DECK



SALON



SALON



SALON



DINING



DINING



DINING



DAY HEAD



GALLEY



GALLEY



GALLEY



DINETTE



DINETTE



PILOTHOUSE



PILOTHOUSE



PILOTHOUSE



PILOTHOUSE / SETTEE



LOWER COMPANIONWAY



MASTER STATEROOM



MASTER STATER



MASTER STATEROOM



MASTER HEAD



MASTER HEAD



MASTER HEAD



MASTER HEAD



VIP STATEROOM



VIP HEAD



GUEST STATEROOM / PORT



GUEST HEAD



GUEST STATEROOM / STARBOARD



GUEST HEAD



BOW



BOW



FLYBRIDGE



FLYBRIDGE / HELM



FLYBRIDGE / SEATING



FLYBRIDGE / BAR



HOT TUB



FLYBRIDGE



FLYBRIDGE



CREW QUARTERS



CREW QUARTERS



CREW QUARTERS



CREW QUARTERS



ENGINE ROOM



ENGINE ROOM



ENGINE ROOM



ENGINE ROOM



SWIM PLATFORM



SWIM PLATFORM



OTHER PROFILE



RUNNING SHOT



RUNNING SHOT



OTHER VIEW



OTHER VIEW



AFT VIEW



7701 GENERAL ARRANGEMENT

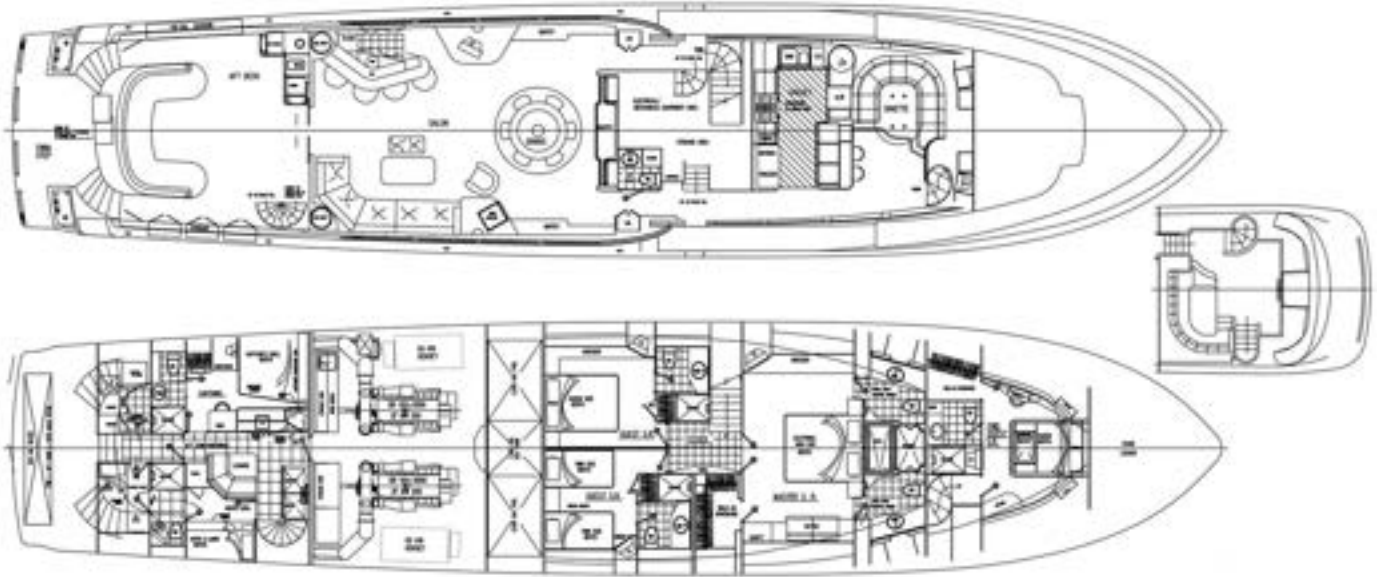

HULL 7701